

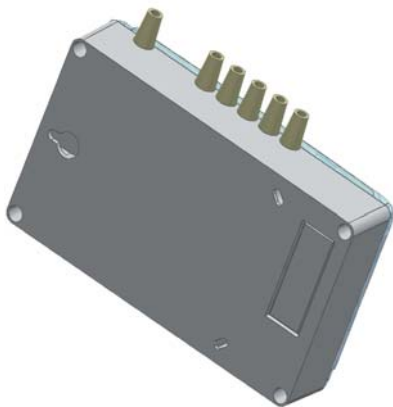









P2-G

Data logger with GSM modem and safety isolation for gas and water meters

P2-G integrates a data logger, GSM modem and safety isolations in a single unit. The internal GSM modem provides a reliable means to communicate data as a part of an AMR, energy management or monitoring system for industrial gas and water metering. **P2-G** belongs to a new generation of Iskraemeco professional communicators based on integrated intelligent i2-GSM™ modem technology developed by Iskraemeco. The gas communicator is approved and manufactured in compliance with the BS EN 60079 and ISO 9001 and designed conform to Iskraemeco's own stringent internal standards derived from extensive field and manufacturing experience.



-  Low power AMR by SMS
-  Intrinsic safety certified
-  Local reading/programming
-  Protection level
-  Data logger
-  Log book
-  4 channel impulse input & output
-  Internal clock
-  Communication bus

- AMR for gas, water and other pulse emitting meters
- Integrated GSM/SMS modem for remote communication
- Low power operation for extended battery life
- Intrinsically safe - safety isolation
- Profile logging of four input channels
- Local re-programming and reading via IR interface using HHU
- Input-to-output impulse re-configuration
- Ambient temperature monitoring
- Compact weatherproof housing for wall or panel

FUNCTIONAL AND TECHNICAL FEATURES

Data logger

The P2-G counts and stores the pulse input totals in half hourly increments.

- Configurable logging interval in the range daily, 30 minutes or 15 minutes
- Storage capacity of 42 days of 30-minute data per channel
- ambient temperature is also logged
- Integrated Real-Time Clock (RTC) allows up to 16 schedules to be defined to select when captured data is transmitted

Inputs

- Four (4) intrinsically safe impulse inputs for direct interface with up to four utility meters, pulse correctors or detection of tamper
- Reed switch, solid state or Wiegand pulse type inputs are accepted
- Pulse counting of all four inputs at frequencies up to 10Hz (bursting to 25Hz)
- Any input can be programmed to be associated with any one of four isolated output circuits
- RS485 local data port to allow connection with other industrial standard devices

Outputs

- Four (4) intrinsically safe volt-free contacts
- Each output is a 250 ms pulse, current sinking output capable of accepting 32V, 50 mA

Event log

Events can be transmitted as alarms. The time and date of the event will be recorded and transmitted via an SMS message. Detected events are:

- removal of the main cover
- Low Battery indication at 90% operational life
- installation
- tamper with the pulse cable

Infrared optical communication port (IEC 62056-21)

- Local data read-out of the historic records for each channel
- Local configuration of the unit during installation or maintenance

AMR communication interface

- Integrated GSM, Dual band 900/1800 MHz modem for a remote transmission of the current readings of the four channels and temperature as an SMS message
- Configurable schedules for start time and period between the SMS transmissions

Power supply

- Factory supplied lithium battery 3.9 V, size D
- Estimated battery life in excess of 5 years assuming one SMS transmission per day
- Easy replacement of the battery on site

Easy installation & commissioning

- Fixing to the wall or any other base by screws; P2-G is not position dependent
- Field initialisation and programming of the unit using HHU

Enclosure

- Made of high durability polycarbonate
- Weatherproof IP66 protection level against dust and water penetration
- Supplied with cables with flying leads for input and output connection

Protection and safety

- Sealed unit cover preventing access to the fixing screws
- Intrinsic safety certificate according to the ATEX Directive:

SIRA 00 ATEX 2394
ex II (1) G [EEx ia] IIC
-20 °C ≤ Ta ≤ +60 °C

Accessories

- MeterView software for programming and data read-out
- IR optical probe with a 9-pin connector

TECHNICAL DATA

No. of pulse inputs.....	4
No. of OptoMOS relay outputs.....	4
Output pulse width.....	250 ms
OptoMOS relay ratings.....	32 V, 50 mA
Switch on resistance.....	< 10 ohms
Switch off resistance.....	> 2 Mohms
Mutual channel isolation.....	2500 VDC
RTC accuracy.....	± 10 ppm
EMC.....	EN61000-6-2 & EN61000-6-3
RF electromagnetic field.....	10V/m (0.1 – 1GHz)
Operating temp. range.....	-20° C ... +60° C
Storage temp. range.....	-25° C ... +75° C
Ambient humidity:.....	<75% annual mean
Dimensions (W x H x D).....	180 x 105 x 44 mm
Mass.....	approx. 0.40 kg

DEVICE TYPE DESIGNATION

P2G-K171V03I03

- P2** – Communicator & Data Logger
G – Explosive environment – gas meters
V – Water meters
K17 – IR + GSM communication modules
1 – RS485 interface
V03 – 4 high impedance pulse inputs
I03 – 4 OptoMOS relay outputs

OVERALL DIMENSIONS (mm)

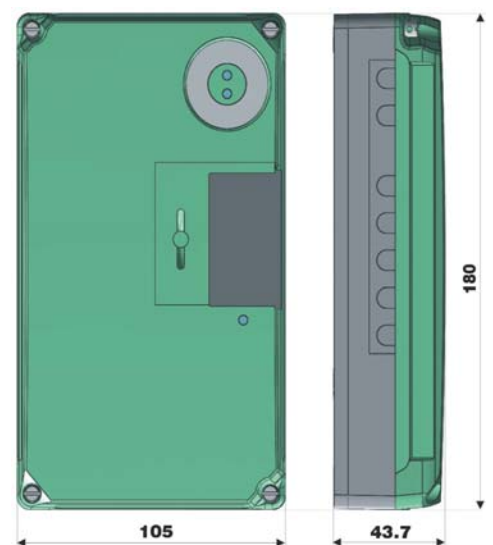

www.meteronline.co.uk

Remote metering using web based mobile technology



Meteronline provides remote metering data to registered account holders via the Internet. Meters and loggers with integrated mobile communications technology transmit their readings via the mobile phone network. Meteronline collects this data from the mobile service providers and presents it to subscribers via the web.

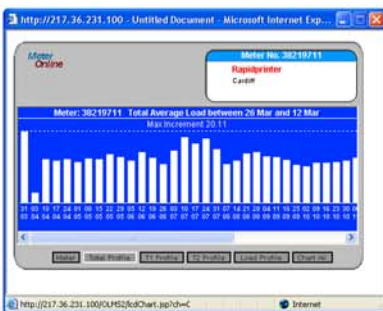

- Load Profiles
- Daily, Weekly & Monthly Reading
- Automatic Billing
- Data Export
- Location Information Database
- Energy Management Displays
- Multi Tariff
- Web Browser Interface
- Easy to Use

- Online service registration
- No additional cabling or equipment needed on site
- Specialised software and commissioning not required
- Readings available at any location
- Installation by electrical contractors or meter installers